



***PRIME LOCATION!***  
**Southcreek Building III**  
**7201 W. 129th St., OPKS**

1,319 rentable sq. ft.

Close to Deer Creek  
Woods Shoppes

Near 169 Highway access



**DDI COMMERCIAL  
INCORPORATED**

***For Lease***

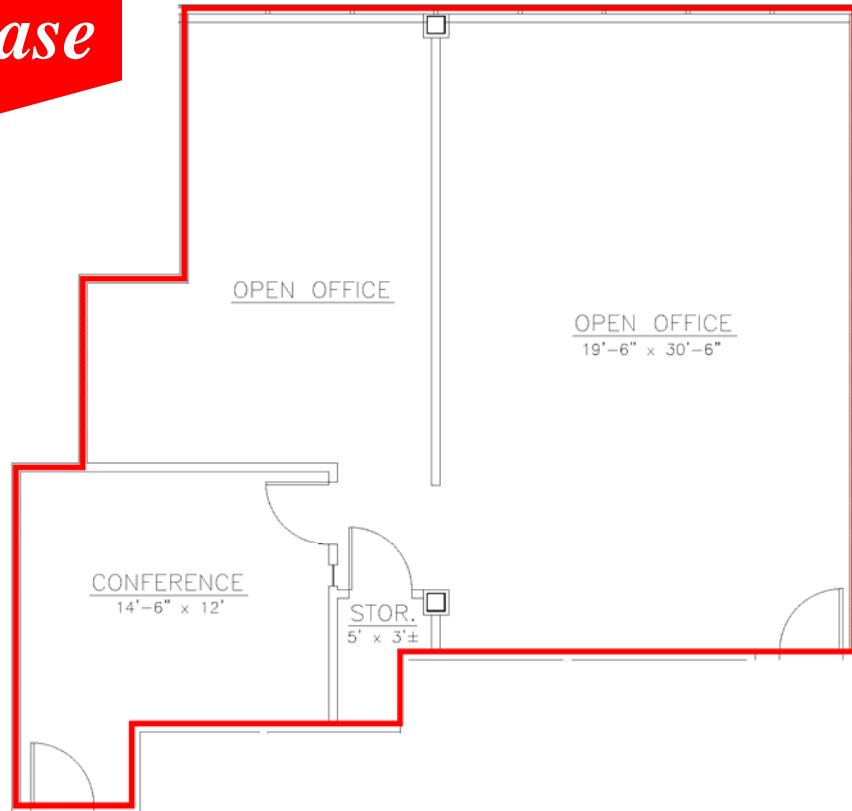

DDI COMMERCIAL, INC.

Elaine Sicht & Kathy Woodward, SIOR  
7200 W. 132nd St. - Suite 300  
Overland Park, KS 66213

Phone: 913.685.4100  
Fax: 913.685.1232  
E-mail: [ddicommercial@aol.com](mailto:ddicommercial@aol.com)  
Web: [www.southcreekoofficepark.com](http://www.southcreekoofficepark.com)