

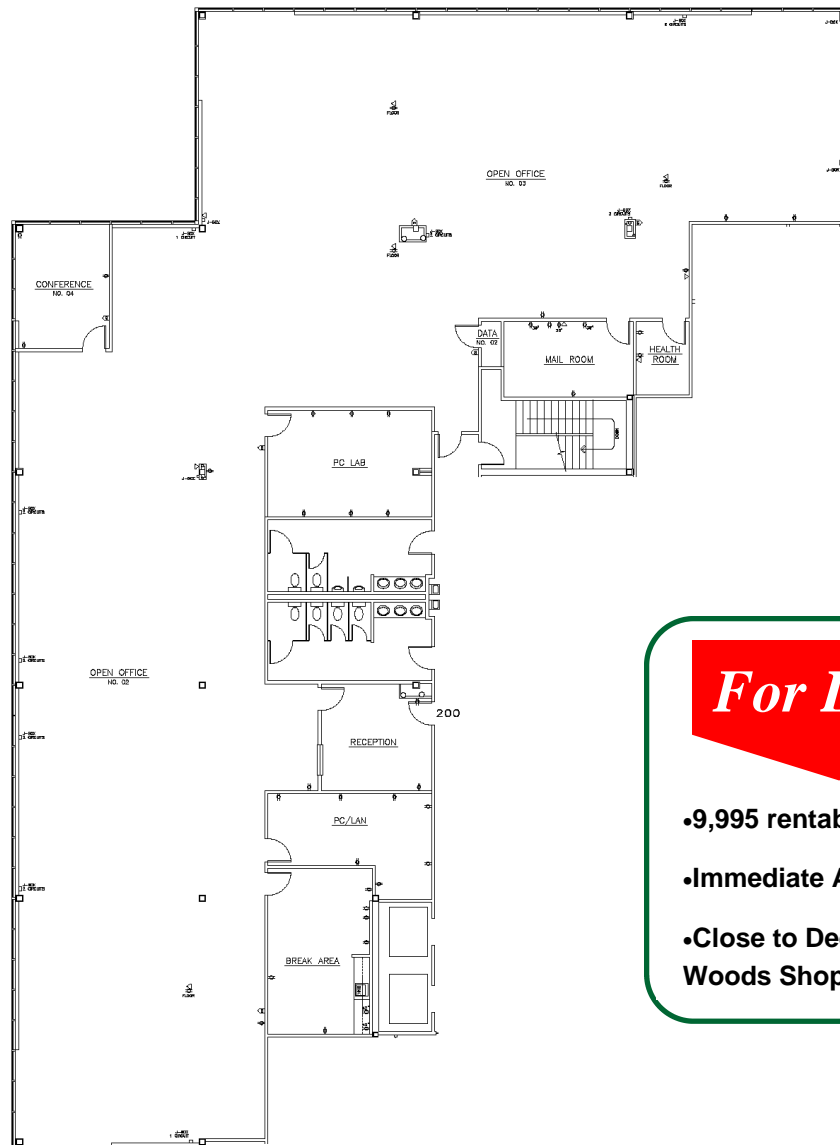

**DDI COMMERCIAL  
INCORPORATED**

***NEW TO MARKET!***

**Southcreek Building VIII  
7415 West 130th Street  
Overland Park, KS 66213**



***For Lease***

- 9,995 rentable sq. ft.
- Immediate Availability
- Close to Deer Creek Woods Shoppes

**DDI COMERCIAL, INC.**

Elaine Sicht & Kathy Woodward, SIOR  
7200 W. 132nd St. - Suite 300  
Overland Park, KS 66213

Phone: 913.685.4100  
Fax: 913.685.1232  
E-mail: [ddicommercial@aol.com](mailto:ddicommercial@aol.com)  
Web: [www.southcreekofficepark.com](http://www.southcreekofficepark.com)