



**Building III—7201 W. 129th St.**

**1,621 sq. ft.**

**Great Corner Suite  
Available April 2024**

**Easy Access to  
Major Highways**

**Close to Fantastic  
Amenities**

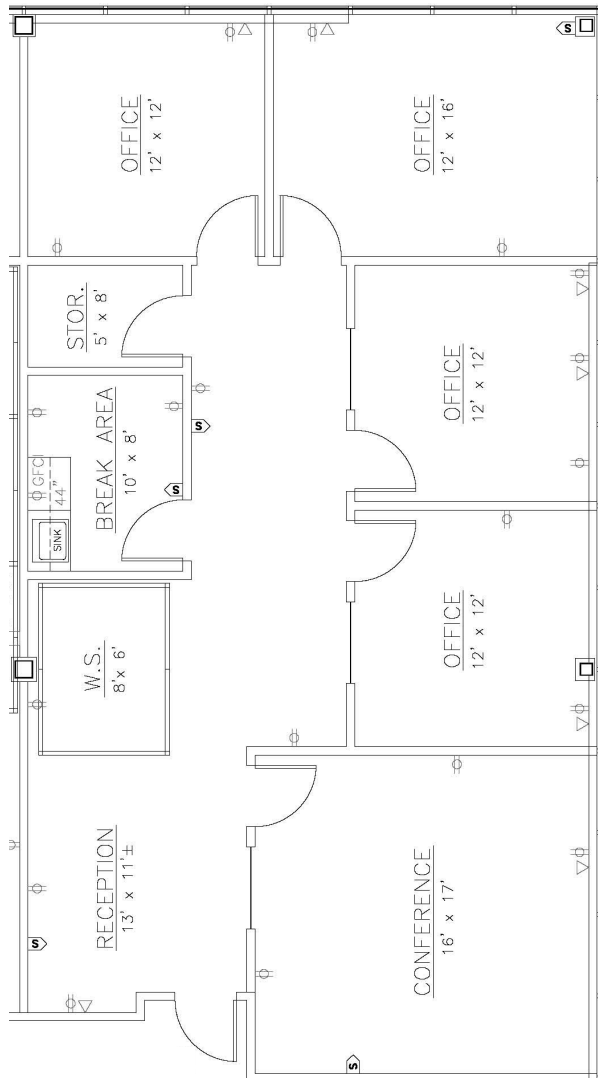

- \* On-site leasing, management & ownership
- \* Cost-effective building designs
- \* Professional floor plan development
- \* Custom interior design services
- \* General contracting by Southcreek
- \* Flexible expansion options
- \* Convenient parking
- \* Excellent location
- \* Beautiful park settings
- \* Commitment to your needs

**Elaine Sight  
Kathy Woodward, SIOR  
DDI COMMERCIAL, INC.**

7200 West 132nd Street  
Suite 300  
Overland Park, KS 66213  
P: 913.685.4100  
F: 913.685.1232

[Elaine@DDIRealty.com](mailto:Elaine@DDIRealty.com)  
[KathyW@DDIRealty.com](mailto:KathyW@DDIRealty.com)  
[DDICommercial@DDIRealty.com](mailto:DDICommercial@DDIRealty.com)  
[www.SouthcreekOfficePark.com](http://www.SouthcreekOfficePark.com)